

Celebrate a New Lifestyle

A Prestigious Address for the New age

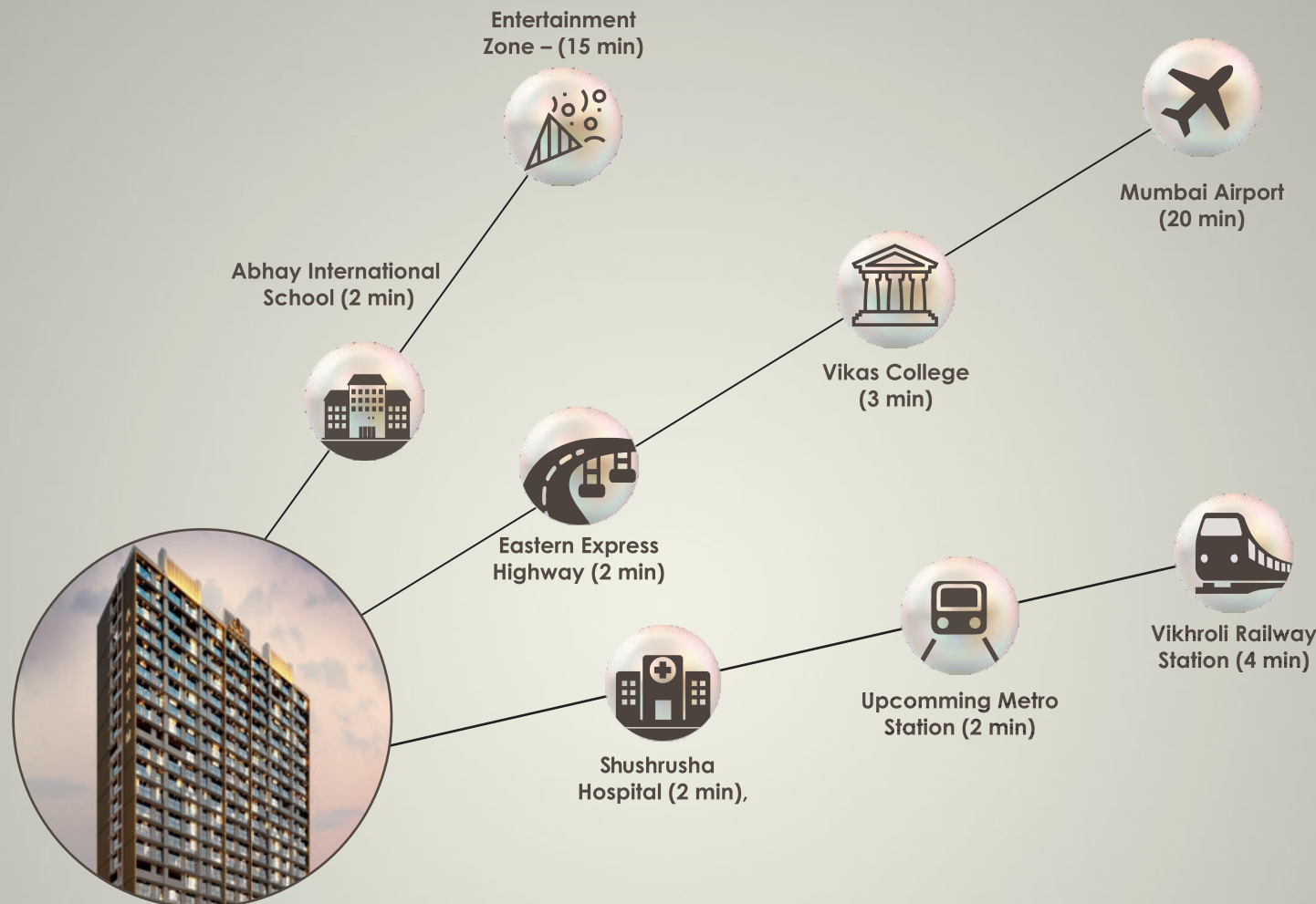

PROJECT HALLMARKS

Project With International Construction Standards

Double Height Lobby + 22 Storey

Luxurious & Ultra Modern 1 & 2 BHK Residences

Close To Eastern Express Highway

Rooftop Sky Life Amenities

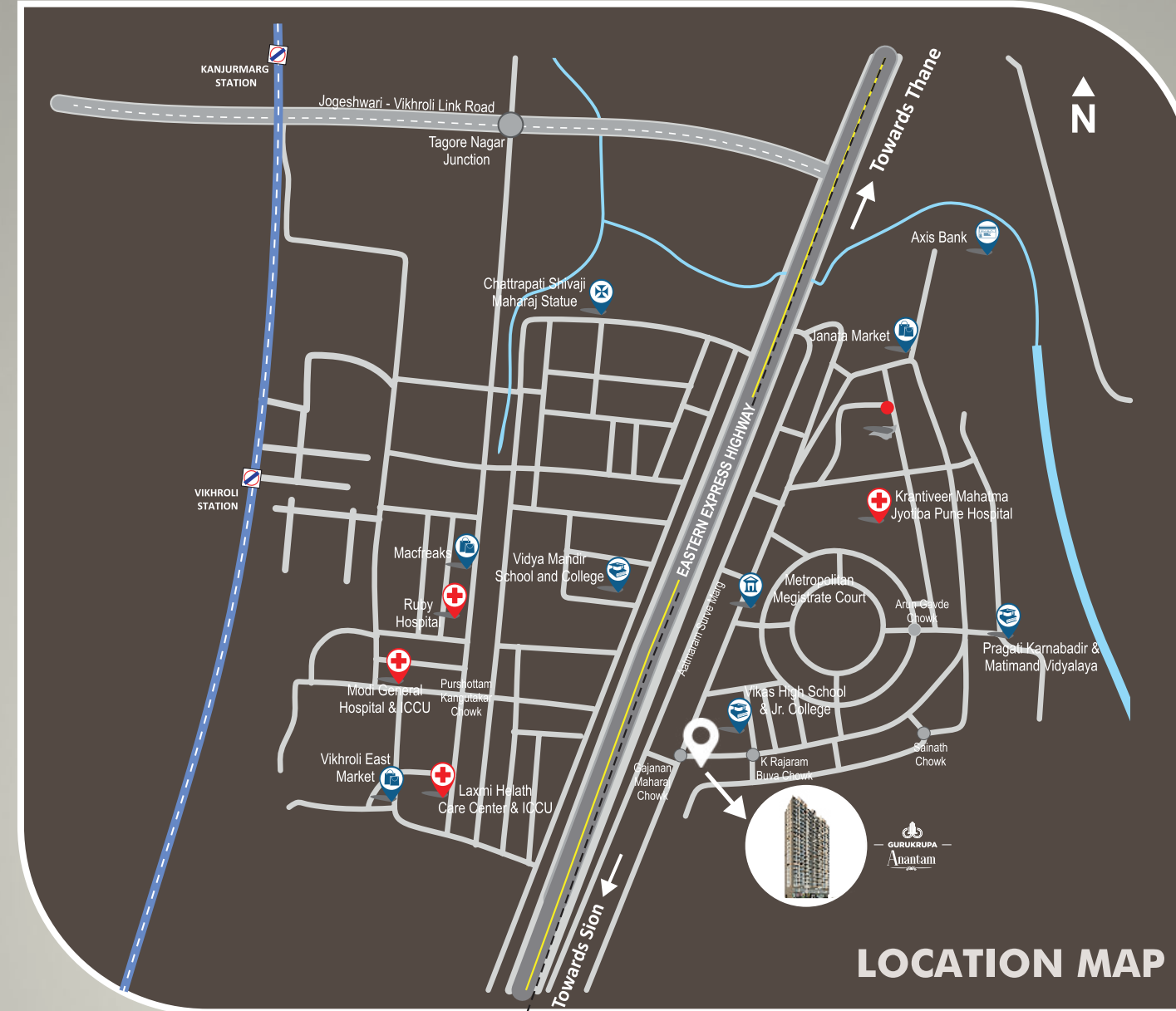

LOCATION MAP



GURUKRUPA REALCON

GURUKRUPA REALCON LIFESPACE LLC

Corp.Add.: C-106, Vashi Plaza, Sector-17, Vashi, Navi Mumbai-400703
Site Add.: Gurukrupa Anantam, Bldg. No 56, Near Gajanan Maharaj Chowk, Kannamwar Nagar 1, Vikhroli (East) Mumbai 400083.

Call: +91 77189 21563 | www.gurukrupagroup.in

MahaRERA: P51900033128 | Web site: <https://maharera.mahaonline.gov.in/>

Disclaimer- The plan, layout plans, the number of towers, specifications, amenities, proposed amenities, images and visuals, drawings plans or sketches and other details shown in this promotional document are only indicative and for illustrative purpose and are intended to convey the concept and vision of the developer for the project. The developer reserves the right to change any or all of these in the interest of the project as per applicable laws, rules and regulations. No representation or warranty is made or intended as to the accuracy or completeness of information and no commitments are being given under this promotional document or as to its suitability or adequacy for any purpose or otherwise howsoever, that the completed project will comply in any degree with such artist's impression as depicted. This promotional document does not constitute an offer and/or contract of any type between the developer and the recipient. All images and dimensions are not intended to form part of any contract or warranty. All Flat/Unit/Shops allotted to be allotted shall be governed by the terms & conditions of the Agreement for Sale entered to be entered into between allottee & developer alongwith approved plans and no det ails mentioned in this promotional document shall in any way govern any such transaction. T&C Apply.



GURUKRUPA

Anantam

ABOUT US

At Gurukrupa Realcon we believe in delivering quality living spaces using international standards of construction along with the most trusted brands in accessories which forms the crux of our everyday work ethics.

With 14 projects across Mumbai with
9 in Ghatkopar, 4 in Vikhroli & 1 in Juhu.

We at Gurukrupa Realcon believe in revolutionizing the way people perceive affordable and quality homes.

10 LAKHS + SQ.FT.
AREA DEVELOPED

45 LAKHS + SQ.FT.
UNDER DEVELOPMENT

1500 +
HAPPY CUSTOMERS

OUR PROJECTS NEARING POSSESSION



GURUKRUPA
UGAM

MahaRERA No: P51800025930
Ghatkopar (E)



GURUKRUPA
DEVAM

MahaRERA No: P51900023724
Ghatkopar (E)



GURUKRUPA
GANGAV

MahaRERA No: P51800027843
Ghatkopar (E)



GURUKRUPA
LABHAM

MahaRERA No: P51900023165
Ghatkopar (E)



GURUKRUPA
JAYANTAM

MahaRERA No: P51900029423
Ghatkopar (E)

OUR ONGOING PROJECTS



GURUKRUPA
SATYAM

MahaRERA No: P51900033311
Vikhroli (E)



GURUKRUPA
GHANSHYAM

MahaRERA No: P51900030149
Ghatkopar (E)



GURUKRUPA
NIGAM

MahaRERA No: P51900034361
Ghatkopar (E)



GURUKRUPA
Divyam

MahaRERA No: P51900034398
Ghatkopar (E)



GURUKRUPA
AAGAM

MahaRERA No: P51900033409
Ghatkopar (E)

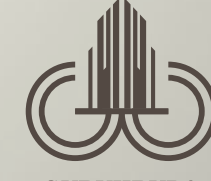

GURUKRUPA
Ekatvam

MahaRERA No: P51900033873
Vikhroli (E)



GURUKRUPA
VYOM

MahaRERA No: P51900031575
Juhu

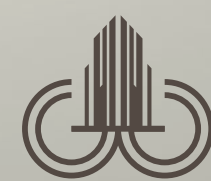

GURUKRUPA
Param

MahaRERA No: P51900033706
Vikhroli (E)



ARTISTIC IMPRESSION



ARTISTIC IMPRESSION



ARTISTIC IMPRESSION



ARTISTIC IMPRESSION



ARTISTIC IMPRESSION

→ Kids Play Area → Net Cricket Turf → Jogging Track → Seating Lounge →

UNIT PLAN

1 BHK - 345 sqft

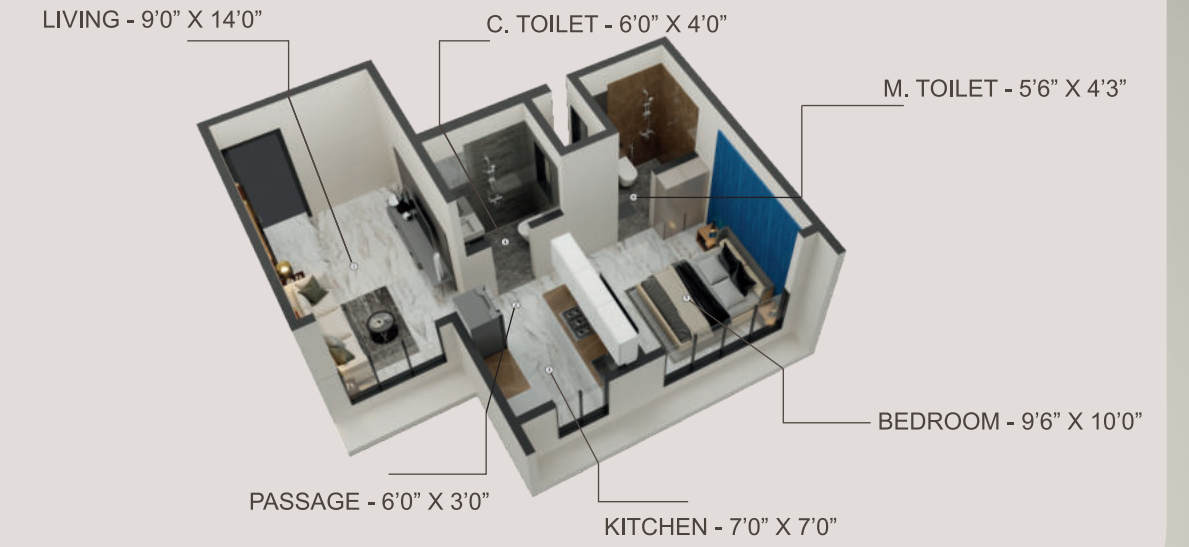

2 BHK - 610 sqft

